

Presented to
IEEE802.1 Plenary session July 2023
July 10, 2023

Proposal Hosting IEEE802.1 January 2024 Interim in Heidelberg Germany

NEC Laboratories Europe

Nader Zein

Chief Engineer

Overview

It is proposed to host the IEEE802.1 Interim in Heidelberg Germany from 22nd to 26th January 2024.



Navigation interface showing travel options from Frankfurt Airport to Heidelberg, Germany.

Transportation modes: Best, 57 min (car), 1 hr 1 (train), 17 hr (walking), 4 hr 15 (bicycle).

Origin: Frankfurt Airport

Destination: Heidelberg, Germany

Buttons: Add destination, Leave now, Options

Feature: Send directions to your phone

Route: via A5 and A67

Duration: 57 min

Distance: 81.5 km

Details

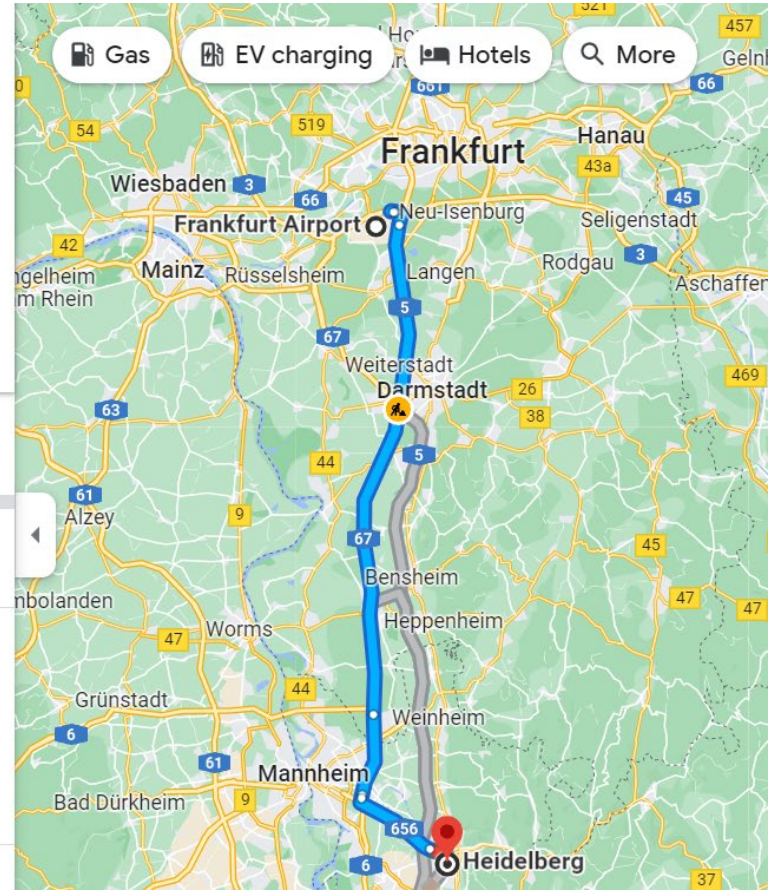

◆ Venue



Hotel reservations Info

Marriott Heidelberg Germany

- Arrival: January 20th 2024
- Departure: January 28th 2024
- Rate (including Breakfast):
 - Single occupancy: € 145,00 per night
 - Double occupancy: € 160,00 per night



YOUR GUESTROOMS

- 100% of the agreed number of delegates free of charge until 4 months prior to arrival (20th September 2023)
- 30% of the agreed number of delegates free of charge until 1 month prior to arrival (20th December 2023)
- 05% of the agreed number of delegates free of charge until 2 weeks prior to arrival (6th January 2024)

The attendees are now able to book their rooms individually under the keyword “IEEE24” via

- telephone: +49 6221 908650
- or under the following link: [Book your group rate for IEEE24](#)

Cancellation of individual rooms:

Until 11.59 pm local time on the day of arrival the cancellation of the rooms will be free of charge. After this time 90% of the room gross rate excluding breakfast will be charged for all nights.

Meeting Rooms

- ◆ All meeting rooms are open daily 09:00 AM – 06:00 PM (see backup slides)
 - Main meeting room Hegel I (300 m²) capacity 80 person.
 - Breakout meeting room Karl Jaspers (152 m²) 40 person
 - Breakout meeting room Ernst Bloch (75 m²) 20 person
- ◆ Unlimited soft drinks in the main meeting room and the breakout rooms
- ◆ 2 coffee breaks with seasonal fruits, savory snacks & pastries, seasonally flavored water, coffee and tea specialties
- ◆ Lunch buffet “à la Chef” or a 3-course-menu
- ◆ Soft drinks, mineral water, coffee & tea during lunch
- ◆ Technical equipment (Beamer, screen, flipchart) in the main meeting room
NLE will arrange for equipment (Beamer, screen and flipchart) in breakout rooms
Audio will be provided for Webex connectivity in main meeting room and large breakout room. For the small room a speaker connected to Webex computer will be used.
- ◆ WIFI within the meeting room & meeting area for all participants
Planning to test the internet speed before the event.

Registration Information

◆ Fees and deadlines

- Registration fees apply to all in-person and remote participation
- Early registration: **700 EUR** until [September the 18th, 2023]
- Standard registration: **900 EUR** until [December the 13th, 2023]
- Late/onsite registration: **1100 EUR** after [December the 13th, 2023]
- Full refund till [September the 19th] (included) and No refunds after [September the 19th, 2023] (end of day, EET)

◆ Practicalities

- Hybrid meeting support
- SSID (to be communicated)
- 3 meeting rooms (sizes: 80, 40, 20)
- Schengen-Visa requests, over registration, an additional email with a passport photo to: TBD

◆ Lunch included daily

◆ 2 coffee breaks with seasonal fruits, savory snacks & pastries, seasonally flavored water, coffee and tea specialties

◆ Further information: such as visa requests and travel information will be provided on registration website

TBD

Possible Social event

Being arranged

- ◆ For social event this could be an option: <https://weisseflottehd.de/charter/>
- ◆ Backup alternative is being investigated

\Orchestrating a brighter world

NEC

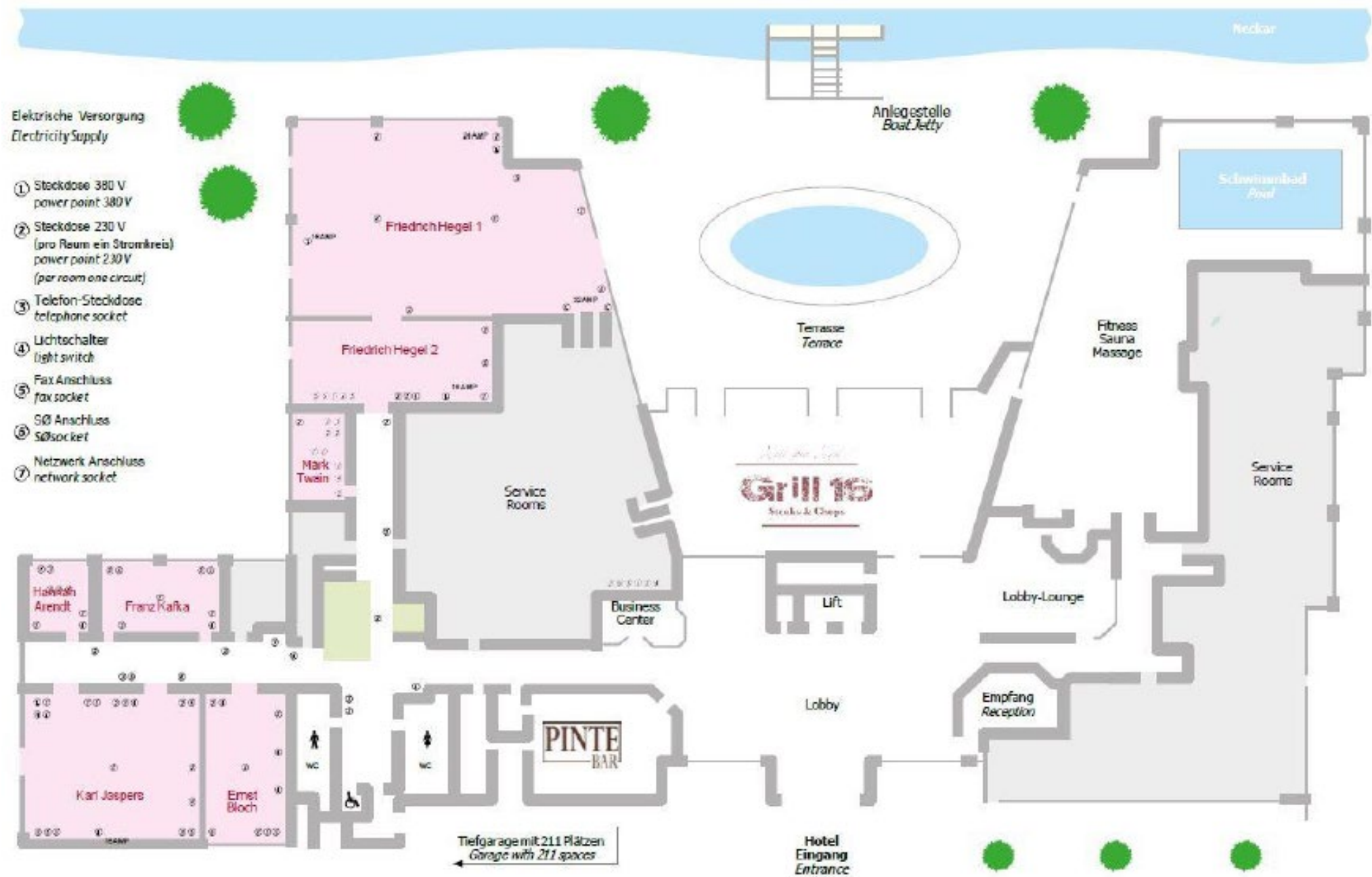

	Wide x Length x Height (meter)	Square Meter	Theater	Schoolroom	Conference	U-Shape	Banquet	Crescent Rounds/ Cabaret	Reception
Friedrich Hegel I	13,9 x 23,1 x 2,94	300	240	180	/	60	170	96	300
Friedrich Hegel II		108	/	36	/	30	/	/	/
Mark Twain	7,3 x 4,3 x 2,94	32	/	/	12	/	/	/	/
Franz Kafka	5,7 x 9,5 x 2,94	54	40	24	24	20	30	12	50
Hannah Arendt	5,7 x 4,7 x 2,94	27	15	12	12	9	10	6	20
Karl Jaspers	11,9 x 12,8 x 2,94	152	153	81	36	36	80	48	150
Ernst Bloch	11,9 x 6,3 x 2,94	75	70	42	30	26	30	24	70
Karl Jaspers & Ernst Bloch	11,9 x 19,1 x 2,94	227	220	132	/	42	120	72	220

The maximum capacities of the individual conference rooms may deviate from the table above in case of legally regulated minimum distances.



GOOD TO KNOW

High-speed Internet Inclusive in the conference area and the public areas of the hotel

Parking Underground car park, fee of € 2.50 per hour, € 25.00 per day

Restaurants Grill 16 & Bar Pinte

Distances Heidelberg Main Station 0.8 km, Frankfurt Airport 80 km

Locations & directions [Google Maps](#)

VAT & Service Charge All rates are inclusive the applicable VAT and service charge.
In case that the level of VAT should increase, the hotel reserves the right to adjust the offered rates accordingly.